



TO LET

232 Valley Mill - 061730 Park Road, Elland, West Yorkshire, HX5 9GY  
£635 PCM

**SW**  
RESIDENTIAL

- Two bedrooms
- Separate Kitchen
- Great location
- Council Tax Band B
- Living Room with balcony
- Furnished
- Available now
- Newly decorated

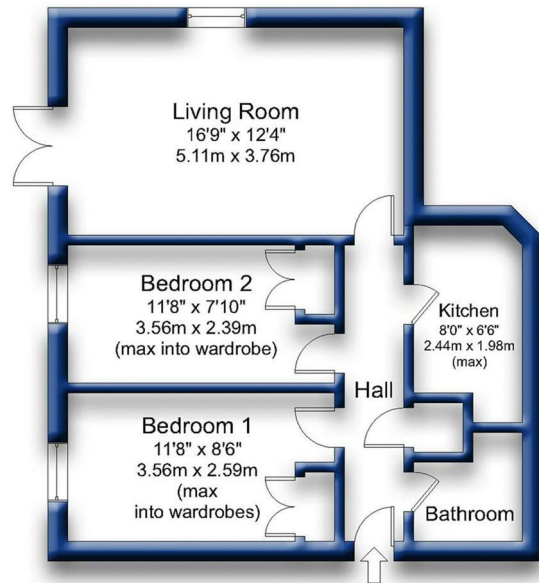

Not to Scale.  
Copyright © Zenith Creations.

## THE PROPERTY

Valley Mill, Park Road, Elland a two bedroom apartment within the prestigious Valley Mill conversion by Clayton homes situated on the edge of the Calder Valley. Within easy reach of Halifax, Brighouse and Leeds with easy access to local transport links and the national motorway network. With two double bedrooms, both with built in wardrobes, living room with double patio doors to good size balcony, separate kitchen with integrated fridge/freezer, full size dishwasher, oven and hob, microwave and washer/dryer. On site car parking spaces available. Available now. Please note the property does not have the benefit of an allocated parking space.

## SITUATION

## Directions